

ELEVATION

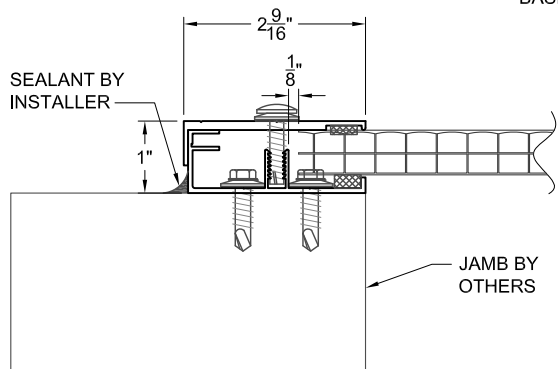

SECTION 'B'

STANDARD ATTACHMENTS:
 ALUMINUM:
 #12 x 1" TEK SCREW W/ #3 TIP & NEOPRENE WASHER

STEEL:
 #12 x 2" TEK SCREW W/ #5 TIP & NEOPRENE WASHER

WOOD:
 1/4" x 2" LAG SCREW W/ NEOPRENE WASHER

NOTE:
 ATTACHMENT METHODS & SPACING BASED ON
 STANDARD 90 MPH WIND LOAD CONDITIONS.
 CONTACT DUO-GARD TO DISCUSS ALTERNATE
 LOAD CONDITIONS.

STANDARD
 ATTACHMENTS
 @ 18" O.C. MAX.

GASKET

VEB BASE CHANNEL

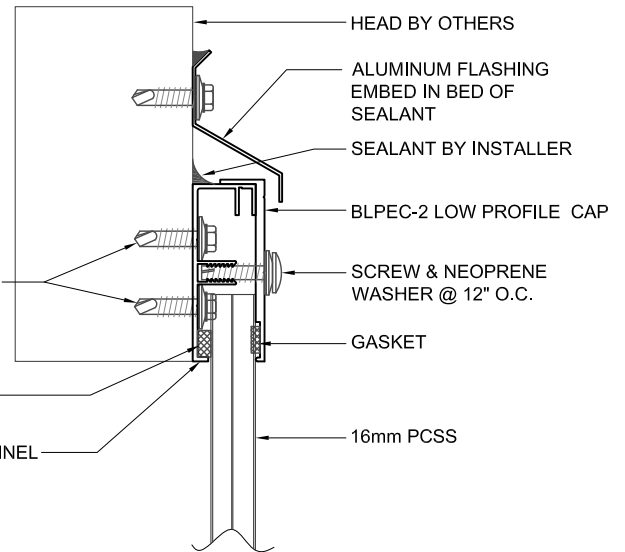

SECTION 'A'

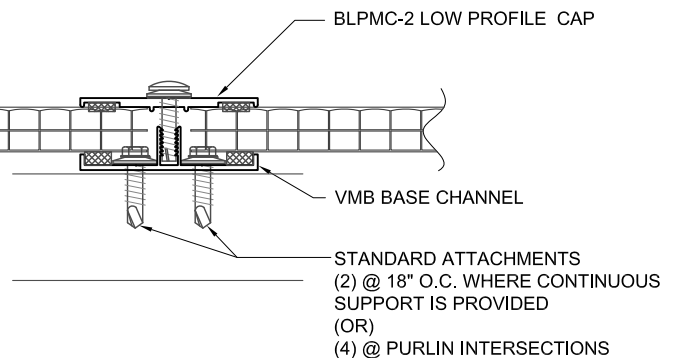

ALUMINUM FLASHING
 EMBED IN BED OF
 SEALANT BY REQUEST

STRUCTURE BY OTHERS
 (ALUMINUM STRUCTURE
 CAN BE PROVIDED)

STANDARD ATTACHMENTS
 @ 18" O.C. MAX.

(2) 3/8" Ø WEEP HOLES
 @ 36" O.C. MAX.
 (ALONG SCREW LINE)

SECTION 'C'



Duo-Gard Industries, Inc.
 Tel (734) 207-9700 Fax (734) 207-7995
 www.duo-gard.com

THIS DRAWING IS PROPRIETARY AND FOR THE SOLE USE OF OUR
 CUSTOMER AND MAY NOT BE COPIED OR REPRODUCED WITHOUT
 PRIOR WRITTEN CONSENT FROM DUO-GARD INDUSTRIES, INC.
 LEAD TIME BEGINS UPON RECEIPT OF SIGNED SHOP DRAWINGS

DESCRIPTION

SERIES 3000 BPC

SYSTEM 3216-3W

DWN BY	DRW'G DATE	SCALE	PAGE	OF	DRWNG #
JL	6/15/16	NTS	1	1	3216-3W G-16-3W FACE