

ELEVATION

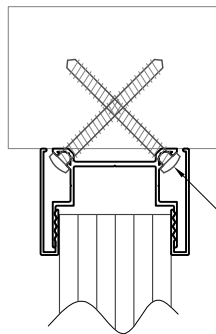

SECTION 'K'

(TYP. FOR HEAD, JAMB & SILL
@ KEY WAY SECTION)

KEY WAY SECTION - ALLOWS PANEL
INSERTION AND SPECIAL MOUNTING
(SEE FULL INSTALLATION INSTRUCTIONS
FOR FURTHER DETAILS)

NOTE CORNER CONDITION:
CAP(S) SQUARE CUT
BASE CHANNEL SQUARE CUT

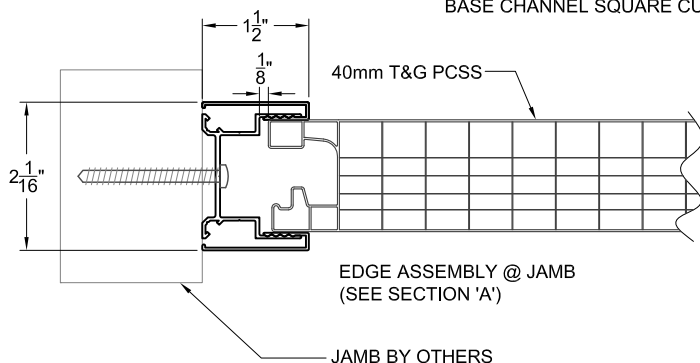

SECTION 'A'

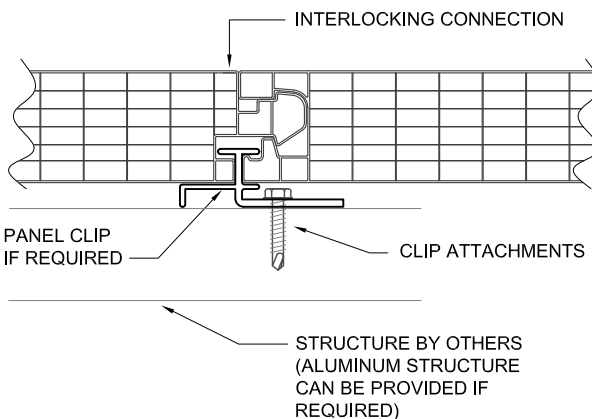
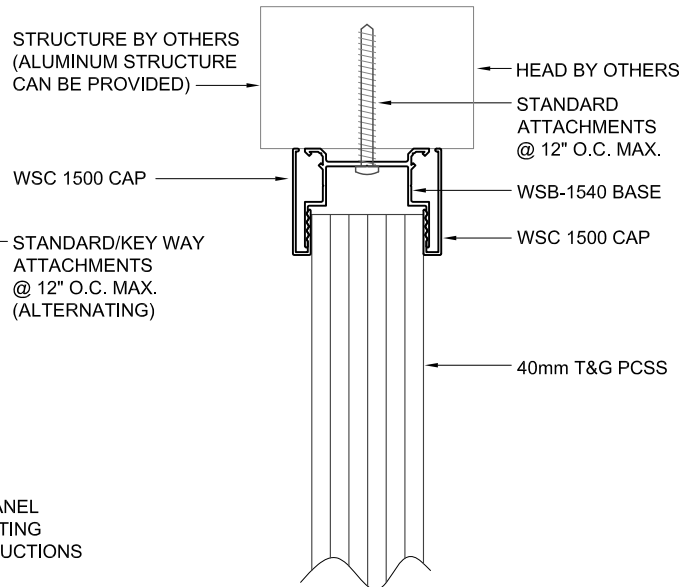

SECTION 'B'

STANDARD ATTACHMENTS:

WOOD:

#8 x 2" PAN HEAD SHEET METAL SCREW

ALUMINUM & STEEL:

#8 x 2" PAN HEAD SHEET METAL SCREW
(PRE-DRILLING MAY BE REQUIRED)

ALTERNATE FASTENERS MAY BE USED:

HEAD DIA. MUST NOT EXCEED 5/16"

CLIP ATTACHMENTS:

ALUMINUM:

#12 x 1" HEX HEAD TEK SCREW W/ #3 TIP

STEEL:

#12 x 2" HEX HEAD TEK SCREW W/ #5 TIP

WOOD:

1/4" x 2" LAG SCREW

NOTE:

GLAZING PANELS CAN BE RUN HORIZONTALLY

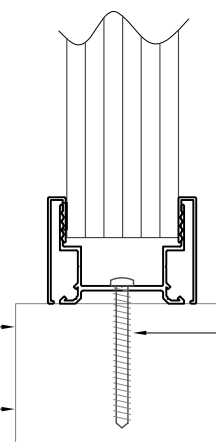

SECTION 'C'



Duo-Gard Industries, Inc.
Tel (734) 207-9700 Fax (734) 207-7995
www.duo-gard.com

THIS DRAWING IS PROPRIETARY AND FOR THE SOLE USE OF OUR
CUSTOMER AND MAY NOT BE COPIED OR REPRODUCED WITHOUT
PRIOR WRITTEN CONSENT FROM DUO-GARD INDUSTRIES, INC.
LEAD TIME BEGINS UPON RECEIPT OF SIGNED SHOP DRAWINGS

DESCRIPTION

SERIES 1000 VERTICAL GLAZE

SYSTEM 1540-7WTG

DWN BY	DRW'G DATE	SCALE	PAGE	OF	DRWNG #
JL	6/13/16	NTS	1	1	1540-7WTG G-40-TG FLUSH